

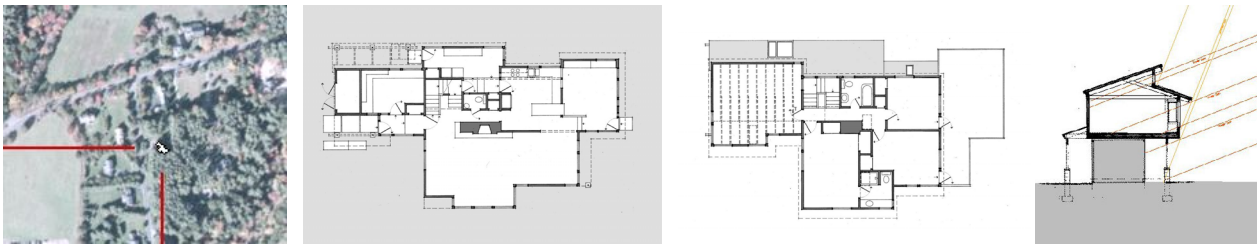

Mill Brook Residence Addition & Renovation, Medfield MA
Peter Wright Studio - Brent Hinrichs, Associated Architect



SITE & PROGRAM

The existing house was set within a grove of pine trees. The new construction of a weaving studio was designed adjacent to the existing upper level of the house. The new studio spans above the former garage, which was converted into a study and a storage area accessed from the exterior. A number of changes made within the existing building included providing a family room with a more open relationship to the surrounding landscape.



MATERIALS & CONSTRUCTION

The working size of the looms required a floor area that was larger than the existing construction below. This dimension allowed for covered access areas to the front and back entrances of the house. As the new floor loads could not be transferred to the existing construction; a spanning floor structure was fabricated of laminated veneer lumber joists and beams bearing on exposed steel columns set to new concrete piers. The site-built roof trusses were designed to provide a section for clerestory lighting of the studio, and these bear on the new 2x wood stud walls of the upper level.



The external surfacing is of painted cedar clapboards and wood trim; the roofing material is an asphalt-fiberglass shingle. Windows, skylights and doors are a combination of stock and custom sized wood frame units. Internally the walls are of painted gypsum-board with clear finished wood trim. The exposed timber trusses are also clear finished. The internal face of the site fabricated insulated roof panels has a light colored surface to reflect light into the weaving studio. The existing hydronic baseboard heating and electrical services were extended into the new construction.